

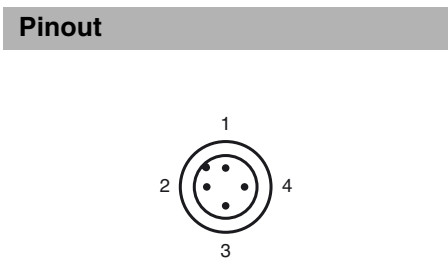

Model Number
NBB2-8GM40-E2-V1

- Features**
- 2 mm embeddable
 - Increased operating distance

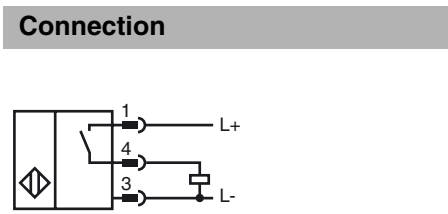

Wire colors in accordance with EN 60947-5-2

1	BN	(brown)
2	WH	(white)
3	BU	(blue)
4	BK	(black)

- Accessories**
- BF 8**
Mounting flange, 8 mm
 - V1-G**
4-pin, M12 female field-attachable connector
 - V1-W**
4-pin, M12 female field-attachable connector
 - V1-G-2M-PUR**
Cable socket, M12, 4-pin, PUR cable
 - V1-W-2M-PUR**
Cable socket, M12, 4-pin, PUR cable
 - EXG-08**
Quick mounting bracket with dead stop

Dimensions

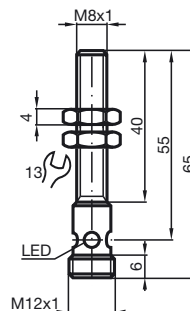

Technical Data

General specifications		
Switching element function	PNP	NO
Rated operating distance	s_n	2 mm
Installation		embeddable
Output polarity		DC
Assured operating distance	s_a	0 ... 1.62 mm
Reduction factor r_{Al}		0.45
Reduction factor r_{Cu}		0.35
Reduction factor r_{304}		0.75
Nominal ratings		
Operating voltage	U_B	10 ... 30 V
Switching frequency	f	0 ... 1500 Hz
Hysteresis	H	typ. 5%
Reverse polarity protected		reverse polarity protected
Short-circuit protection		pulsing
Voltage drop	U_d	≤ 3 V
Operating current	I_L	0 ... 100 mA
Off-state current	I_r	0 ... 0.5 mA typ. 0.1 μ A
No-load supply current	I_0	≤ 15 mA
Indication of the switching state		Multihole-LED, yellow
Functional safety related parameters		
MTTF _d		2730 a
Mission Time (T_M)		20 a
Diagnostic Coverage (DC)		0 %
Ambient conditions		
Ambient temperature		-25 ... 70 °C (-13 ... 158 °F)
Mechanical specifications		
Connection type		Device connector M12 x 1, 4-pin
Housing material		brass, nickel-plated
Sensing face		LCP
Protection degree		IP67
Compliance with standards and directives		
Standard conformity		
Standards		EN 60947-5-2:2007 IEC 60947-5-2:2007

Approvals and certificates	
UL approval	cULus Listed, General Purpose
CSA approval	cCSAus Listed, General Purpose
CCC approval	Products with a maximum operating voltage of ≤ 36 V do not bear a CCC marking because they do not require approval.

Release date: 2011-07-07 14:19 Date of issue: 2012-02-03 085181_eng.xml